

# Autodesk® Navisworks® 2016 Service Pack 4

Guide to features and enhancements

January 2016

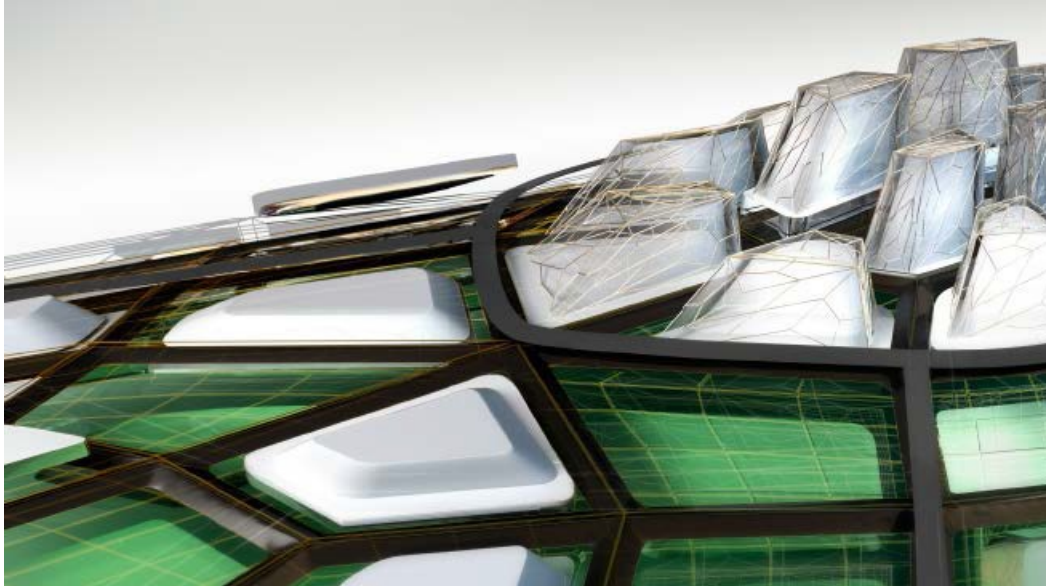

Please send feedback on this guide to: [navisworks.productmanager@autodesk.com](mailto:navisworks.productmanager@autodesk.com)

# Contents

- Guide to features and enhancements ..... 1
- Primary issues resolved by the Service Pack..... 5
  - European Regional Support ..... 5
  - CADWorx Custom Data ..... 5
  - Issues ..... 5

## Primary issues resolved by the Service Pack

Autodesk Navisworks 2016 Service Pack 4 provides the following fixes and enhancements:

### European Regional Support

Navisworks Desktop client provides access to BIM 360 Glue projects hosted both in the United States and Europe. Just select your regional server after sign-in.

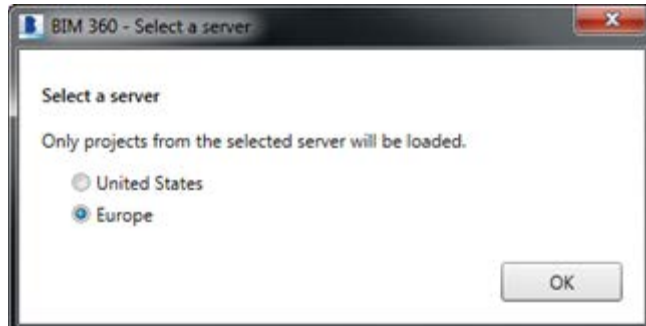

### CADWorx Custom Data

The service pack provides an enhancement to CADWorx options, which means you can assign additional fields using the Custom Data button. In Navisworks we changed the way CADWorx lists are converted to show just the current value for the list rather than all possible values. This means that Navisworks matches the way values are displayed in CADWorx.

### Issues

- Resolved an issue where opening Inventor or Revit models could cause Navisworks to hang with no further updates to the progress bar and the user unable to cancel.
- Resolved an issue where Navisworks reports an internal error when opening a DWG containing CADPipe objects on a machine with CADPipe installed.
- Resolved an issue in the export to DWF where area and volume were preceded by comma and semicolon
- Resolved an issue where not all full enclosed elements were being selected by the box selection tool.
- Resolved an issue where the RVM reader did not support RVM files sizes greater than 2GB