

AUTODESK® NAVISWORKS® 2018 Update 2

Guide to features and enhancements

October 2017

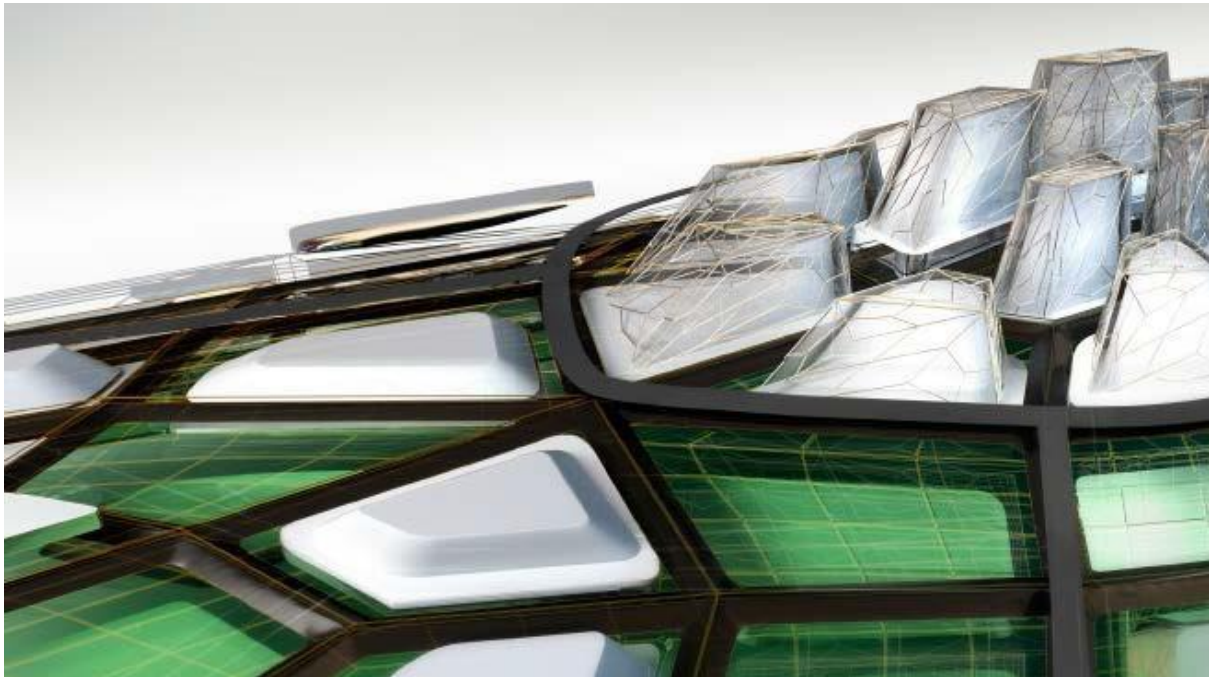

Please send feedback on this guide to: navisworks.productmanager@autodesk.com

Contents

Introduction.....	3
Primary issues resolved by the Update	4
Enhancements.....	4
Fixes.....	4
IFC Loader.....	4
Redlines	4
CERs	4
Rendering.....	5
Other	5

Navisworks® 2018 Update 2 Readme

Introduction

Thanks for downloading the Navisworks® 2018 Update 2

This update includes several enhancements and fixes, many of which have been identified by you. Your opinion really matters to us. It helps us to continually improve Navisworks and provide the best possible solution to you, our customers!

If you see any more issues in this release, don't hesitate to report them! We value your insight, continued business, and feedback.

Many thanks,

The Navisworks Team

Primary issues resolved by the Update

The Navisworks 2018 Update 2 provides the following enhancements and fixes:

Enhancements

- LMV users will now see a clear error message when the Navisworks extractor fails
- In Recap, a viewpoint is saved at the origin of each scan
- Navisworks now supports the ability to outline cross-sections

Fixes

IFC Loader

- Imported IFC files now include classification data so that it can be used to create search sets
- Model hierarchy is now preserved when using the Revit_IFC loader, to help find information more efficiently
- Resolved an issue where Revit AddIns for IFC Loader cannot work if Navisworks 2018 is uninstalled, then reinstalled
- Resolved an issue where Navisworks 2018 crashes when an IFC file with reinforced bars is imported

Redlines

Resolved issues where:

- Newly drawn redlines can remove previous redlines
- Redlines with a thickness that is increased to >1 display as dotted lines

CERs

Resolved issues where:

- Navisworks 2018 crashes when an IFC file with reinforced bars is imported
- Navisworks 2018 crashes when importing a dwg file
- Navisworks 2017 crashes when a Civil dwg file is opened
- Navisworks crashes and memory is corrupted when loading an NWD/NWF file that has been sorted
- Navisworks crashes when an appended group of dwg files are opened
- Navisworks Freedom crashes whilst accessing Application Manager

Navisworks® 2018 Update 2 Readme

Rendering

Resolved issues where:

- Navisworks 2018 Render spotlight settings are locked
- Measure tool does not display dashed lines to show XYZ distances

Other

Resolved issues where:

- Failure to log into Navisworks with BIM 360 licensing logs you out of all other Autodesk applications
- Build task hierarchy does not work with Navisworks 2014 and 2015 sample files